

PEMCO®

E-LINE *Economical & In-Stock*

*2" Wide Casters, Wheels
and Accessories*



**Internal Brake Arm Stays
Protected From Forklifts
and Other Equipment!**



KWL

MAX

GFP

Three NEW Wheel Offerings!



**DOWNLOAD
3D CAD MODELS**

See back cover for details

www.PemcoCasters.com/E-Line

E-LINE

The E-line is an economical lineup of casters and wheels designed and mass-produced for a range of medium-duty applications with load requirements ranging from 300 to 1,250 lbs. per caster. From shop carts and containers, to platform and lumber carts, the E-Line is your most competitive and in-stock 2" wide solution.

- The industry's most popular 2" wide caster sizes, wheel options, brake configurations, and accessories.
- Capacities up to 1,250 lbs. per caster.
- Double ball raceways for smooth swiveling action.
- 1/4" thick steel leg construction on swivel and rigid casters. 3/16" construction on total lock casters.
- 5/8" diameter permanent rivet kingpin.
- RoHS compliant industrial zinc finish for corrosion resistance.
- 1/2" hollow axle with grease zerk and lock nut.
- Total lock permanently integrated into swivel fork on total lock models.

Swivel Brake Options



Total Lock
Integrated into swivel fork ... locks and unlocks both wheel and swivel with a toe tap. Models shown in chart.



Wheel Face Brake (WFB)



Tread Lock Brake (TBK)



Short Pedal - 5" Length Cam Brake (CAMS)



Long Pedal - 7" Length Cam Brake (CAML)

Roller Bearing required for CAM Brakes. Not available on Solid Polyurethane K or PolyKat™

Rigid Brake Options



Wheel Face Brake (not available on 4" and 5" rigid models) (WFB)



Tread Lock Brake (TBK)



Short Pedal - 5" Length Cam Brake (CAMS)



Long Pedal - 7" Length Cam Brake. Not available on 4" and 5" rigid models. (CAML)

*Roller Bearing required for CAM Brakes.

Wheel Options

POLYURETHANE TREAD WHEELS



PolyKat™ Thermo-Urethane



Thermo-Urethane



Solid Polyurethane K



Mold-on Poly

RUBBER/THERMORUBER CUSHION WHEELS



Mold-on Rubber



Thermo-Rubber Flat



Thermo-Rubber Donut

HARD TREAD WHEELS



Glass Filled Polypropylene



Maxim® Glass Filled Nylon



Phenolic



Polypropylene HD



Cast Iron

See wheel features and descriptions on page 4.

Bearing Options



Roller Standard (R)



Pedestal Precision Ball (B)



Delrin® (D)



Precision Ball Standard on PolyKat (P8) and KWL (B) wheels.

To specify the optional Pedestal Precision Ball (B) or Delrin (D) bearing in a caster, please add B or D to the end of the Part # (see following pages). To order bearing alone, please see Page 5.

Retainer Washer Option

Standard



Plastic Retainer Washer

Optional



Steel Retainer Washer (SW)

Plastic retainer washers come standard on wheels with roller bearings; to order optional steel retainer washers add SW to the end of the part#. Example ES6X2CIRSW

Sealed Raceway Option

Rubber raceway seals keeps dirt out and lube in for longer caster life. Add RS after ES for free swivel models (example: ESRS6X2TPR). Seals are not recommended when swivel locks are used.



Wheel Dia.	Tread Width	Wheel Type	¹ Load Capacity (lbs)	Mount Height	² Swivel Radius	Standard Bearing	Swivel Caster Part #	Rigid Caster Part #	Total Lock ¹ Brake	³ Caster Bearing Options	⁴ Other Brake Options	
4"	2"	TPR Thermo-Rubber (Flat)	300	5-5/8"	3-3/8"	Roller	ES4X2TPR	ER4X2TPR	ET4X2TPR	(+) B, D	(+) WFB, TBK, CAMS, CAML	
		TPD Thermo-Rubber (Donut)	300	5-5/8"		Roller	ES4X2TPD	ER4X2TPD	ET4X2TPD	(+) B, D		
		MOR Mold-on Rubber	400	5-5/8"		Roller	ES4X2MOR	ER4X2MOR	ET4X2MOR	(+) B		
		TUM Thermo-Urethane	500	5-5/8"		Pedestal Ball	ES4X2PKTP8	ER4X2PKTP8	ET4X2PKTP8	None		
		POD Polypropylene HD	500	5-5/8"		Roller	ES4X2POD	ER4X2POD	ET4X2POD	(+) B, D		
		PKT PolyKat™ Thermo-Urethane	600	5-5/8"		Roller	ES4X2TUM	ER4X2TUM	ET4X2TUM	(+) B, D		
		KWL Solid Polyurethane K	700	5-5/8"		Pedestal Ball	ES4X2KWL	ER4X2KWL	ET4X2KWL	(+) D	(+) WFB, TBK	
		MOP Mold-on Poly	800	5-5/8"		Roller	ES4X2MOP	ER4X2MOP	ET4X2MOP	(+) B	(+) WFB, TBK, CAMS, CAML	
		GFP Glass-Filled Polypropylene	800	5-5/8"		Roller	ES4X2GFP	ER4X2GFP	ET4X2GFP	(+) B, D		
		MAX Maxim® Glass-Filled Nylon	800	5-5/8"		Roller	ES4X2MAX	ER4X2MAX	ET4X2MAX	(+) B, D		
		PHN Phenolic	800	5-5/8"		Roller	ES4X2PHN	ER4X2PHN	ET4X2PHN	(+) B, D		
		CIR Cast Iron	800	5-5/8"		Roller	ES4X2CIR	ER4X2CIR	ET4X2CIR	(+) B		
5"	2"	TPR Thermo-Rubber (Flat)	350	6-1/2"	4"	Roller	ES5X2TPR	ER5X2TPR	ET5X2TPR	(+) B, D		(+) WFB, TBK, CAMS, CAML
		TPD Thermo-Rubber (Donut)	350	6-1/2"		Roller	ES5X2TPD	ER5X2TPD	ET5X2TPD	(+) B, D		
		MOR Mold-on Rubber	400	6-1/2"		Roller	ES5X2MOR	ER5X2MOR	ET5X2MOR	(+) B		
		TUM Thermo-Urethane	600	6-1/2"		Roller	ES5X2TUM	ER5X2TUM	ET5X2TUM	(+) B, D		
		POD Polypropylene HD	600	6-1/2"		Roller	ES5X2POD	ER5X2POD	ET5X2POD	(+) B, D		
		PKT PolyKat™ Thermo-Urethane	800	6-1/2"		Pedestal Ball	ES5X2PKTP8	ER5X2PKTP8	ET5X2PKTP8	None		
		KWL Solid Polyurethane K	1000	6-1/2"		Pedestal Ball	ES5X2KWL	ER5X2KWL	ET5X2KWL	(+) D	(+) WFB, TBK	
		MOP Mold-on Poly	1100	6-1/2"		Roller	ES5X2MOP	ER5X2MOP	ET5X2MOP	(+) B	(+) WFB, TBK, CAMS, CAML	
		GFP Glass-Filled Polypropylene	1000	6-1/2"		Roller	ES5X2GFP	ER5X2GFP	ET5X2GFP	(+) B, D		
		MAX Maxim® Glass-Filled Nylon	1000	6-1/2"		Roller	ES5X2MAX	ER5X2MAX	ET5X2MAX	(+) B, D		
		PHN Phenolic	1000	6-1/2"		Roller	ES5X2PHN	ER5X2PHN	ET5X2PHN	(+) B, D		
		GFP Glass-Filled Polypropylene	1000	6-1/2"		Roller	ES5X2GFP	ER5X2GFP	ET5X2GFP	(+) B, D		
		MAX Maxim® Glass-Filled Nylon	1000	6-1/2"		Roller	ES5X2MAX	ER5X2MAX	ET5X2MAX	(+) B, D		
		PHN Phenolic	1000	6-1/2"		Roller	ES5X2PHN	ER5X2PHN	ET5X2PHN	(+) B, D		
		CIR Cast Iron	1000	6-1/2"		Roller	ES5X2CIR	ER5X2CIR	ET5X2CIR	(+) B		
		6"	2"	TPR Thermo-Rubber (Flat)		500	7-1/2"	4-3/4"	Roller	ES6X2TPR		ER6X2TPR
TPD Thermo-Rubber (Donut)	500			7-1/2"	Roller	ES6X2TPD	ER6X2TPD		ET6X2TPD	(+) B, D		
MOR Mold-on Rubber	550			7-1/2"	Roller	ES6X2MOR	ER6X2MOR		ET6X2MOR	(+) B		
POD Polypropylene HD	600			7-1/2"	Roller	ES6X2POD	ER6X2POD		ET6X2POD	(+) B, D		
TUM Thermo-Urethane	720			7-1/2"	Roller	ES6X2TUM	ER6X2TUM		ET6X2TUM	(+) B, D		
PKT PolyKat™ Thermo-Urethane	1200			7-1/2"	Pedestal Ball	ES6X2PKTP8	ER6X2PKTP8		ET6X2PKTP8	None		
KWL Solid Polyurethane K	1200			7-1/2"	Pedestal Ball	ES6X2KWL	ER6X2KWL		ET6X2KWL	(+) D	(+) WFB, TBK	
MOP Mold-on Poly	1200			7-1/2"	Roller	ES6X2MOP	ER6X2MOP		ET6X2MOP	(+) B	(+) WFB, TBK, CAMS, CAML	
GFP Glass-Filled Polypropylene	1200			7-1/2"	Roller	ES6X2GFP	ER6X2GFP		ET6X2GFP	(+) B, D		
MAX Maxim® Glass-Filled Nylon	1200			7-1/2"	Roller	ES6X2MAX	ER6X2MAX		ET6X2MAX	(+) B, D		
PHN Phenolic	1200			7-1/2"	Roller	ES6X2PHN	ER6X2PHN		ET6X2PHN	(+) B, D		
CIR Cast Iron	1200			7-1/2"	Roller	ES6X2CIR	ER6X2CIR		ET6X2CIR	(+) B		
8"	2"	MOR Mold-on Rubber	600	9-1/2"	6-1/4"	Roller	ES8X2MOR	ER8X2MOR	ET8X2MOR	(+) B		(+) WFB, TBK, CAMS, CAML
		TPR Thermo-Rubber (Flat)	600	9-1/2"		Roller	ES8X2TPR	ER8X2TPR	ET8X2TPR	(+) B, D		
		TPD Thermo-Rubber (Donut)	600	9-1/2"		Roller	ES8X2TPD	ER8X2TPD	ET8X2TPD	(+) B, D		
		TUM Thermo-Urethane	800	9-1/2"		Roller	ES8X2TUM	ER8X2TUM	ET8X2TUM	(+) B, D		
		POD Polypropylene HD	900	9-1/2"		Roller	ES8X2POD	ER8X2POD	ET8X2POD	(+) B, D		
		PKT PolyKat™ Thermo-Urethane	1200	9-1/2"		Pedestal Ball	ES8X2PKTP8	ER8X2PKTP8	ET8X2PKTP8	None		
		KWL Solid Polyurethane K	1250	9-1/2"		Pedestal Ball	ES8X2KWL	ER8X2KWL	ET8X2KWL	(+) D	(+) WFB, TBK	
		MOP Mold-on Poly	1250	9-1/2"		Roller	ES8X2MOP	ER8X2MOP	ET8X2MOP	(+) B	(+) WFB, TBK, CAMS, CAML	
		GFP Glass-Filled Polypropylene	1250	9-1/2"		Roller	ES8X2GFP	ER8X2GFP	ET8X2GFP	(+) B, D		
		MAX Maxim® Glass-Filled Nylon	1250	9-1/2"		Roller	ES8X2MAX	ER8X2MAX	ET8X2MAX	(+) B, D		
		PHN Phenolic	1250	9-1/2"		Roller	ES8X2PHN	ER8X2PHN	ET8X2PHN	(+) B, D		
		CIR Cast Iron	1250	9-1/2"		Roller	ES8X2CIR	ER8X2CIR	ET8X2CIR	(+) B		

¹ Maximum weight capacity of total lock brake casters is 900 lbs. each.

² Swivel radius shown in above table is for standard swivel plate models; for brake swivel radius see table to right.

³ Available optional bearings are shown in this column. To order add appropriate code. Delrin example: ES4X2MAXD. For KWL change **B** to **D**. ESX2KWL

⁴ To order with an optional brake, add brake code to end of swivel or rigid caster part #. Tread lock brake example with roller bearing: ES6X2TPR**TBK**. Tread lock brake example with Precision ball bearing: ES6X2TPR**BTBK**.

Wheel Diameter	Brake Swivel Radius			
	Total Lock	Wheel Face Brake (WFB)	Tread Lock Brake (TBK)	Cam Brake (CAM)
4"	5-7/16"	6-1/4"	4"	5"
5"	5-13/16"	6-7/8"	4-1/4"	5-1/8"
6"	6"	7-5/8"	4-3/4"	6-1/4"
8"	6-3/5"	8-1/2"	6-1/8"	6-3/4"

Top Plate Dimensions

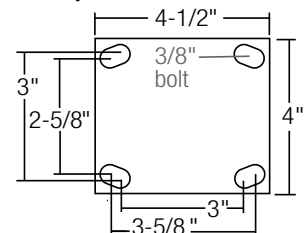

Wheel Features

PolyKat™ Thermo-Urethane

- Premium Polyurethane on Glass reinforced Polypropylene core
- Maintenance free, sealed precision ball bearings
- Excellent roll-ability and floor protection.
- High load capacity and impact strength.
- Good in wet applications, resistant to most chemicals

Durometer: 55 Shore D (±5)



PKT

Thermo-Urethane

- Polyurethane tread mechanically locked to polypropylene core
- Attractive, all-purpose wheel
- Good in wet applications, resistant to most chemicals

Durometer: 95 Shore A (±5)



TUM

Solid Polyurethane K

- Molded from a high strength urethane compound
- Solid wheel eliminates any possibility of tread separation
- Good in wet applications, resistant to most chemicals
- Wheel works with Torrington style roller bearing

Durometer: 55 Shore D (±5)



KWL

Mold-on Poly

- Polyurethane bonded to cast iron core
- High load capacity
- Good roll-ability and floor protection

Durometer: 95 Shore A (±5)



MOP

Mold-on Rubber

- Rubber bonded to cast iron core
- Quiet, shock absorbing ride

Durometer: 85 Shore A (±5)



MOR

Thermo-Rubber Flat and Donut

- Non-marking tread
- Good floor protection
- Quiet, shock absorbing ride
- Good in wet environments, resistant to most chemicals

MADE IN USA



TPR

TPD

Durometer: 90 Shore A (±5)

Glass Filled Polypropylene

- Stronger than standard Polypropylene
- Higher capacity compared to standard Polypropylene

Durometer: 65 Shore D (±5)



GFP

Maxim® Glass Filled Nylon

- Excellent load capacity
- Superior in wet environments, resistant to most chemicals

Durometer: 85 Shore D (±5)



MAX

Phenolic

- High load capacity.
- Hard tread, rolls easily
- Excellent impact strength
- Abrasion resistant

Durometer: 90 Shore D (±5)



PHN

Wheels Only Options

Wheel Dia.	Tread Width	Wheel Type	Standard Bearing	Load Capacity (lbs)	Bearing Bore	Wheel Part # Standard Bearing	Bearing Options	Wheel Part # No Bearing
4"	2"	TPR Thermo-Rubber (Flat)	Roller	300	1/2"	WH4X2TPRR	(+) B, D	WH4X2TPR19
		TPD Thermo-Rubber (Donut)	Roller	300	1/2"	WH4X2TPDR	(+) B, D	WH4X2TPD19
		MOR Mold-on Rubber	Roller	400	1/2"	WH4X2MORR	(+) B	WH4X2MOR19
		TUM Thermo-Urethane	Roller	500	1/2"	WH4X2TUMR	(+) B, D	WH4X2TUM19
		POD Polypropylene HD	Roller	500	1/2"	WH4X2PODR	(+) B, D	WH4X2POD19
		PKT PolyKat™ Thermo-Urethane	Pedestal Ball	600	1/2"	WH4X2PKTP8	N/A	—
		KWL Solid Polyurethane K	Pedestal Ball	700	1/2"	WH4X2KWLP8	(+) D	WH4X2KWL19
		MOP Mold-on Poly	Roller	800	1/2"	WH4X2MOPR	(+) B	WH4X2MOP19
		GFP Glass-Filled Polypropylene	Roller	800	1/2"	WH4X2GFPR	(+) B, D	WH4X2GFP19
		MAX Maxim® Glass-Filled Nylon	Roller	800	1/2"	WH4X2MAXR	(+) B, D	WH4X2MAX19
		PHN Phenolic	Roller	800	1/2"	WH4X2PHNR	(+) B, D	WH4X2PHN19
		CIR Cast Iron	Roller	800	1/2"	WH4X2CIRR	(+) B	WH4X2CIR19
5"	2"	TPR Thermo-Rubber (Flat)	Roller	350	1/2"	WH5X2TPRR	(+) B, D	WH5X2TPR19
		TPD Thermo-Rubber (Donut)	Roller	350	1/2"	WH5X2TPDR	(+) B, D	WH5X2TPD19
		MOR Mold-on Rubber	Roller	400	1/2"	WH5X2MORR	(+) B	WH5X2MOR19
		TUM Thermo-Urethane	Roller	600	1/2"	WH5X2TUMR	(+) B, D	WH5X2TUM19
		POD Polypropylene HD	Roller	600	1/2"	WH5X2PODR	(+) B, D	WH5X2POD19
		PKT PolyKat™ Thermo-Urethane	Pedestal Ball	800	1/2"	WH5X2PKTP8	N/A	—
		KWL Solid Polyurethane K	Pedestal Ball	1000	1/2"	WH4X2KWLP8	(+) D	WH4X2KWL19
		GFP Glass-Filled Polypropylene	Roller	1000	1/2"	WH5X2GFPR	(+) B, D	WH5X2GFP19
		MAX Maxim® Glass-Filled Nylon	Roller	1000	1/2"	WH5X2MAXR	(+) B, D	WH5X2MAX19
		PHN Phenolic	Roller	1000	1/2"	WH5X2PHNR	(+) B, D	WH5X2PHN19
		CIR Cast Iron	Roller	1000	1/2"	WH5X2CIRR	(+) B	WH5X2CIR19
		MOP Mold-on Poly	Roller	1100	1/2"	WH5X2MOPR	(+) B	WH5X2MOP19
6"	2"	TPR Thermo-Rubber (Flat)	Roller	500	1/2"	WH6X2TPRR	(+) B, D	WH6X2TPR19
		TPD Thermo-Rubber (Donut)	Roller	500	1/2"	WH6X2TPDR	(+) B, D	WH6X2TPD19
		TUM Thermo-Urethane	Roller	720	1/2"	WH6X2TUMR	(+) B, D	WH6X2TUM19
		MOR Mold-on Rubber	Roller	550	1/2"	WH6X2MORR	(+) B	WH6X2MOR19
		POD Polypropylene HD	Roller	600	1/2"	WH6X2PODR	(+) B, D	WH6X2POD19
		PKT PolyKat™ Thermo-Urethane	Pedestal Ball	1200	1/2"	WH6X2PKTP8	N/A	—
		KWL Solid Polyurethane K	Pedestal Ball	1200	1/2"	WH6X2KWLP8	(+) D	WH6X2KWL19
		MOP Mold-on Poly	Roller	1200	1/2"	WH6X2MOPR	(+) B	WH6X2MOP19
		GFP Glass-Filled Polypropylene	Roller	1200	1/2"	WH6X2GFPR	(+) B, D	WH6X2GFP19
		MAX Maxim® Glass-Filled Nylon	Roller	1200	1/2"	WH6X2MAXR	(+) B, D	WH6X2MAX19
		PHN Phenolic	Roller	1200	1/2"	WH6X2PHNR	(+) B, D	WH6X2PHN19
		CIR Cast Iron	Roller	1200	1/2"	WH6X2CIRR	(+) B	WH6X2CIR19
8"	2"	TPR Thermo-Rubber (Flat)	Roller	600	1/2"	WH8X2TPRR	(+) B, D	WH8X2TPR19
		TPD Thermo-Rubber (Donut)	Roller	600	1/2"	WH8X2TPDR	(+) B, D	WH8X2TPD19
		MOR Mold-on Rubber	Roller	600	1/2"	WH8X2MORR	(+) B	WH8X2MOR19
		TUM Thermo-Urethane	Roller	800	1/2"	WH8X2TUMR	(+) B, D	WH8X2TUM19
		POD Polypropylene HD	Roller	900	1/2"	WH8X2PODR	(+) B, D	WH8X2POD19
		PKT PolyKat™ Thermo-Urethane	Pedestal Ball	1200	1/2"	WH8X2PKTP8	N/A	—
		MOP Mold-on Poly	Roller	1250	1/2"	WH8X2MOPR	(+) B	WH8X2MOP19
		PHN Phenolic	Roller	1250	1/2"	WH8X2PHNR	(+) B, D	WH8X2PHN19
		CIR Cast Iron	Roller	1250	1/2"	WH8X2CIRR	(+) B	WH8X2CIR19
		GFP Glass-Filled Polypropylene	Roller	1400	1/2"	WH8X2GFPR	(+) B, D	WH8X2GFP19
		MAX Maxim® Glass-Filled Nylon	Roller	1400	1/2"	WH8X2MAXR	(+) B, D	WH8X2MAX19
		KWL Solid Polyurethane K	Pedestal Ball	1500	1/2"	WH8X2KWLP8	(+) D	WH8X2KWL19

Roller bearing is standard for all above wheels except PolyKat and KWL models which include Pedestal Precision Ball bearings. However, Torrington style roller bearings will fit the KWL wheels. For optional Pedestal Precision Ball bearings, change last letter in part # from **R** to **B**; for Delrin® bearing change the last letter from **R** to **D**. Bearings include spanner bushings when necessary. Plastic retainer washers come standard on wheels with roller bearings; to order optional steel retainer washers add **SW** to the end of the part number.

Polypropylene HD

- Lightweight economical wheel.
- Good load capacity
- Excellent impact strength
- Superior in wet environments, resistant to most chemicals

Durometer: 70 Shore D (±5)



POD

Cast Iron

- Solid 1 piece construction
- High load capacity
- Hard tread, rolls easily
- Excellent impact strength
- For high temperature up to 600°F – must use optional steel retainer washers (**SW**)



CIR

Thread Guard Options



Thread Guards help keep debris out of the wheel bearings. To order: add **TG1** for metal or **TG2** for plastic, to the end of the caster part number. TG2 option only available on TPR & TPD wheels in 5", 6" & 8" diameters – no other wheels currently available with TG2 option.

E-LINE Components

Swivel and Rigid Rigs



Wheel Dia.	Tread Width	*Load Capacity (lbs)	Mount Height	Swivel Caster Part #	Rigid Caster Part #
4"	2"	1250	5-5/8"	RIG4X2ES	RIG4X2ER
5"	2"	1250	6-1/2"	RIG5X2ES	RIG5X2ER
6"	2"	1250	7-1/2"	RIG6X2ES	RIG6X2ER
8"	2"	1250	9-1/2"	RIG8X2ES	RIG8X2ER



Total Lock Rigs

Wheel Dia.	Tread Width	*Load Capacity (lbs)	Mount Height	Swivel Radius	Part #
4"	2"	900	5-5/8"	5-7/16"	RIG4X2EST
5"	2"	900	6-1/2"	5-13/16"	RIG5X2EST
6"	2"	900	7-1/2"	6"	RIG6X2EST
8"	2"	900	9-1/2"	6-3/8"	RIG8X2EST

*Some wheels have lower capacities. See pemcocasters.com/eline for specifications.

Brake Kits

All brake kits include axle, nut and necessary hardware to install on swivel or rigid rigs.

Tread Lock Brake (TBK)



TBK4X2E	4" models
TBK5X2E	5" models
TBK6X2E	6" models
TBK8X2E	8" models

Wheel Face Brake (WFB)



WFB4X2E	4" models
WFB5X2E	5" models
WFB6X2E	6" models
WFB8X2E	8" models

Long Pedal Cam Brake 7" (CAML)

Only works with roller bearing models. Fits 5", 6" & 8" E-Line models.



CAMXX2L	Comes with custom spanner bushing (roller bearing required)
---------	---

Short Pedal Cam Brake 5" (CAMS)

Only works with roller bearing models. Fits all caster sizes.



CAMXX2S	Comes with custom spanner bushing (roller bearing required)
---------	---

Floor Lock Options

Single Pedal Floor Locks

Designed to hold your portable equipment in a desired location.



Wheel Dia.	Caster Mtg. Ht.	Retracted Clearance	Approximate Weight (lbs)	Floor Lock #
4"	5-5/8"	3/4"	3-1/4	FL-4E
5"	6-1/2"	3/4"	3-1/2	FL-5E
6"	7-1/2"	3/4"	3-3/4	FL-6E
8"	9-1/2"	3/4"	4	FL-8E

Hardware (All hardware parts sold per piece, not sets)



Axle (Zerk)
1/2-13x3.62
AXLEZRKEX2



Nut
1/2-13
AXLENUTEX2



Spanner bushing
1/2 X 3/4 X 2-7/16
SPANNEREX2



Retaining Washer (Plastic)
WHLCAPLEX2



Retaining Washer (Steel)
WHLCAPSTEX2



Roller bearing
3/4 I.D. (Use With Bushing For 1/2 I.D.)
BRGROLLEX2



Pedestal precision bearing
BRGPBALLEX2



Flanged Delrin bearing
3/4 I.D. (Use With Bushing For 1/2 I.D.)
BRGDELRNEX2

Raceway Seals

Upper and Lower seals available on swivel caster models (Sold as set). Seals are not recommended when swivel locks are used.



RCWYSEALEX2

4 Position Swivel Lock

Lock and unlock swivel for easy tracking down hallways



SWVLOCKX2

Double Pedal Floor Locks

Adaptable to all types of portable equipment, the double pedal floor lock allows for easier floor lock engagement.



Wheel Dia.	Caster Mtg. Ht.	Retracted Clearance	Approximate Weight (lbs)	Floor Lock #
4"	5-5/8"	1"	3-7/8"	FLOCKE40
5"	6-1/2"	1"	4	FLOCKE50
6"	7-1/2"	1-3/8"	4-1/4	FLOCKE60
8"	9-1/2"	1-1/4"	4-3/4	FLOCKE80



NEED A CAD MODEL OR QUOTE?

www.PemcoCasters.com



Part Number	ES6X2TUM
Series	E-Line Series
Category	General Caster
Capacity	6,000
Wheel Size	2
Wheel Type	Thermo-Urethane (ManureGrey)
Wheel Height	7 1/2
Wheel Width	4 3/4
Wheel Tread	Rubber
Caster Stroke	None
Mounting	720

“Caster CAD 3D” App

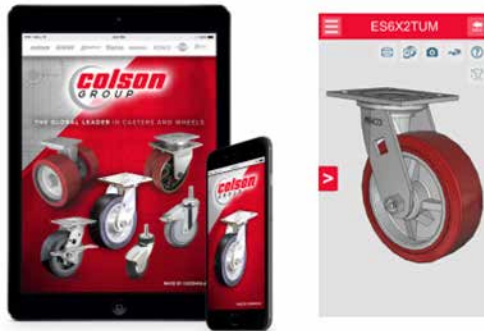

- Quickly configure caster models
- Download native CAD formats
- Download datasheets
- Easily share with your team



Pemco Casters

A Brand of Colson Group

800-258-0868



THE GLOBAL LEADER
IN CASTERS AND WHEELS.