

Pnuline™

*The Ultimate Value in
Pneumatic Casters*



THE GLOBAL LEADER
IN **CASTERS AND WHEELS.**

PEMCO
www.pemcocasters.com

Pnuline™ The Ultimate Value in Pneumatic Casters



Pemco Pnuline Pneumatic casters are recommended for the greatest possible protection to both load and floor, or for off-road applications. If you transport fragile materials or parts, or if you move equipment over rough floors, you should consider this economical product offering. Full pneumatics cushion the load on air – just like automobile or truck wheels.

Caster Features

- Weight capacities to 450 lbs.
- Double ball raceways for smooth swiveling action
- Zerk fitting in swivel raceway for easy maintenance
- 3/16" thick steel leg construction
- 5/8" diameter kingpin
- RoHS compliant industrial zinc finish for corrosion resistance
- Standard top plate bolt hole pattern:

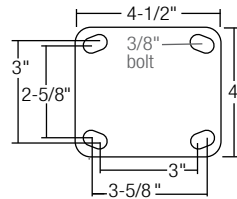

Wheel Features

- 4-Ply sawtooth pattern wheel treads for better traction and appearance
- Zerk fitting for easy axle maintenance
- Standard air nozzle for easy air pressure maintenance
- Precision ball bearing for smooth rolling ease
- Zinc plated rims for corrosion resistance



Caster Models and Specifications

Wheel Dia.	Tread Width	Max. Air Pressure	Wheel Type	Tire to Rim Distance	Rim Dia.	Bearing	Load Capacity (lbs)	Mount Height	Swivel Radius	Swivel Caster Part #	Swivel Caster With Brake Part #	Rigid Caster Part #
8"	2.80"	50 PSI	2.80/2.50-4	2.50"	4"	Precision Ball	300	10"	6-9/16"	PNU80SWL	PNU80SWLB	PNU80RGD
10"	4.10"	50 PSI	4.10/3.50-4	3.50"	4"	Precision Ball	350	12"	7-11/16"	PNU10SWL	PNU10SWLB	PNU10RGD
12"	4.10"	30 PSI	4.10/3.50-6	3.25"	6.5"	Precision Ball	450	15-3/16"	9-3/16"	PNU12SWL	PNU12SWLB	PNU12RGD

Wheel Models and Specifications

Wheel Dia.	Tread Width	Max. Air Pressure	Wheel Type	Tire to Rim Distance	Rim Dia.	Bearing	Load Capacity (lbs)	Bore ID	Bearing ID	Wheel Part #
8"	2.80"	50 PSI	2.80/2.50-4	2.50"	4"	Precision Ball	300	1/2"	1/2"	WH8X2.5PNU
10"	4.10"	50 PSI	4.10/3.50-4	3.50"	4"	Precision Ball	350	1/2"	1/2"	WH10X3.5PNU
12"	4.10"	30 PSI	4.10/3.50-6	3.25"	6.5"	Precision Ball	450	1/2"	1/2"	WH12X3.5PNU



Free CAD MODELS & DATASHEETS

EXPLORE • DOWNLOAD • SHARE



- Quickly configure interactive 3D models
- Download in native CAD formats
- Download interactive product datasheets
- Easily share with your entire team

Explore Online

// Visit pemcocasters.com

or On-the-Go



// Search "Caster CAD 3D"

Pemco

A Brand of Colson Group USA
203 Kerth Street
Saint Joseph, MI 49085
Phone: 800-968-9631